

OVERVIEW

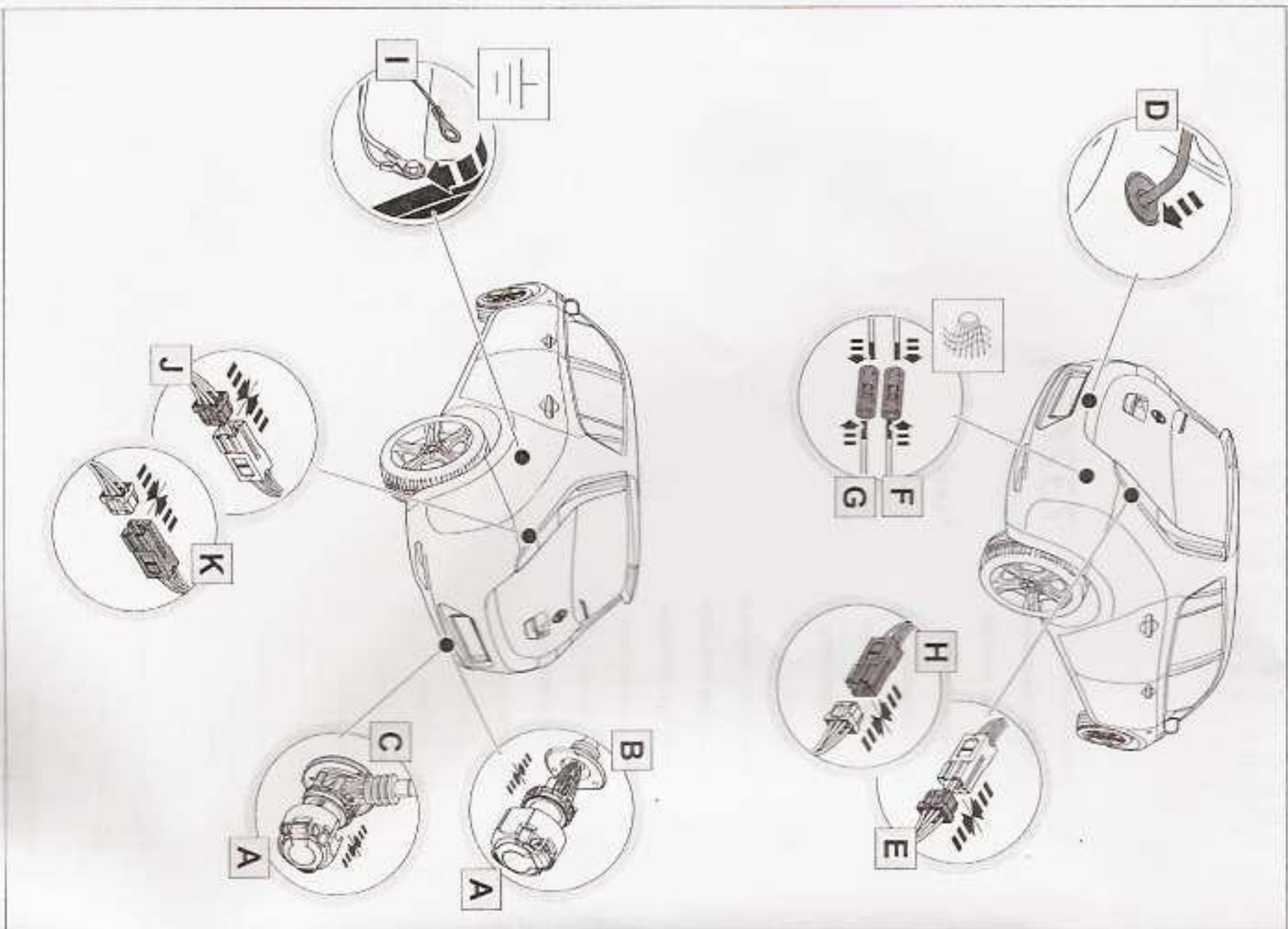

KIT

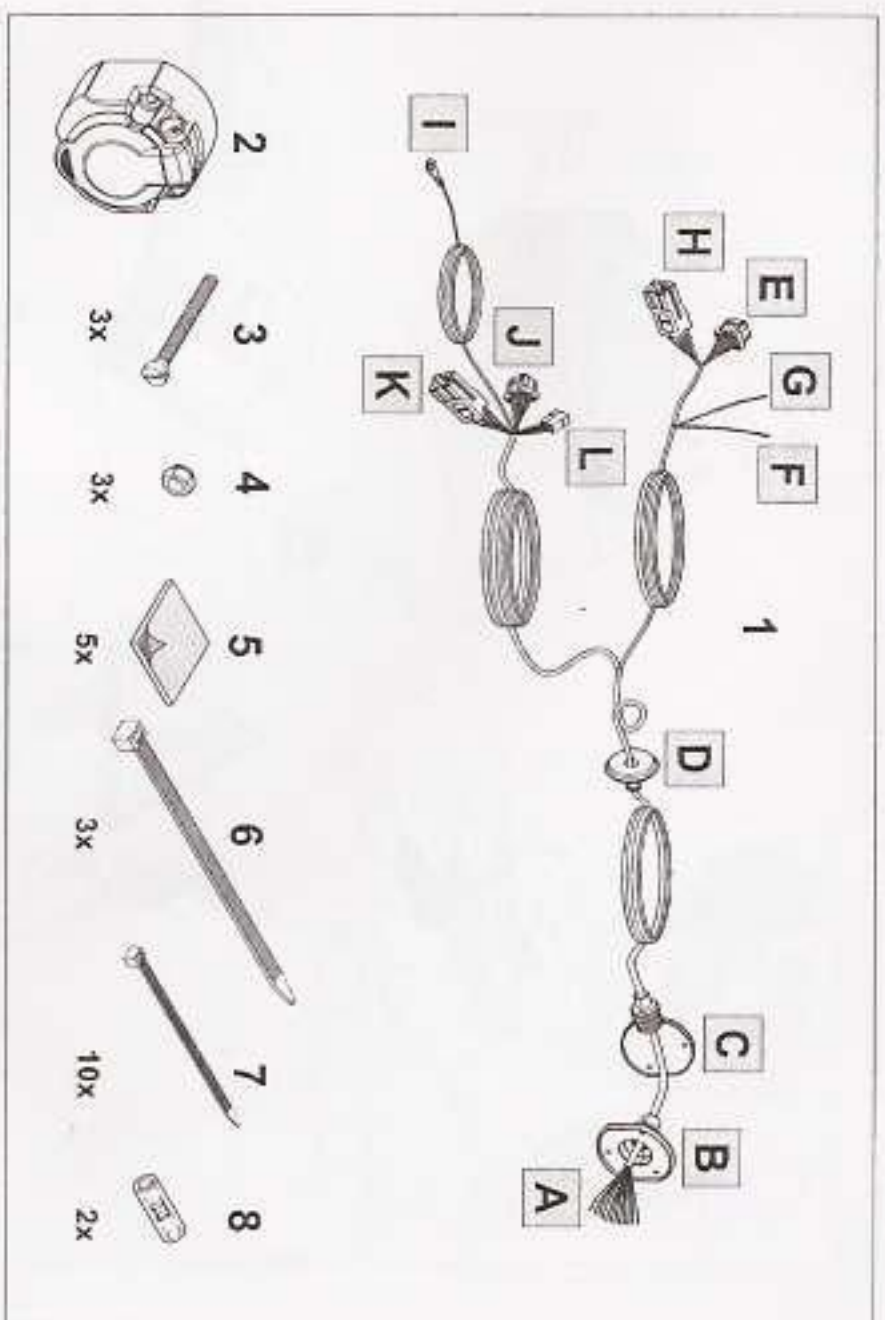

TOOLS

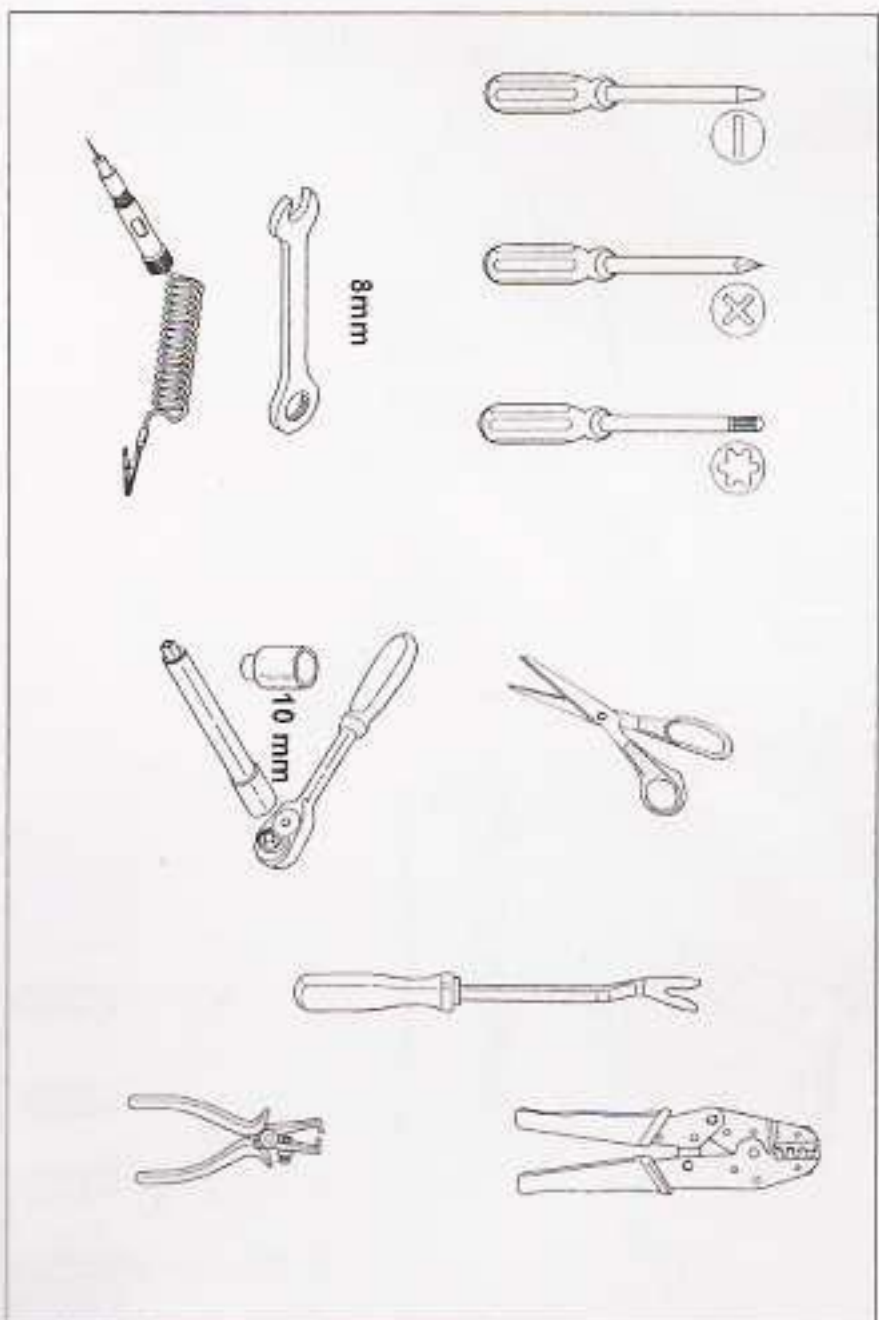

1

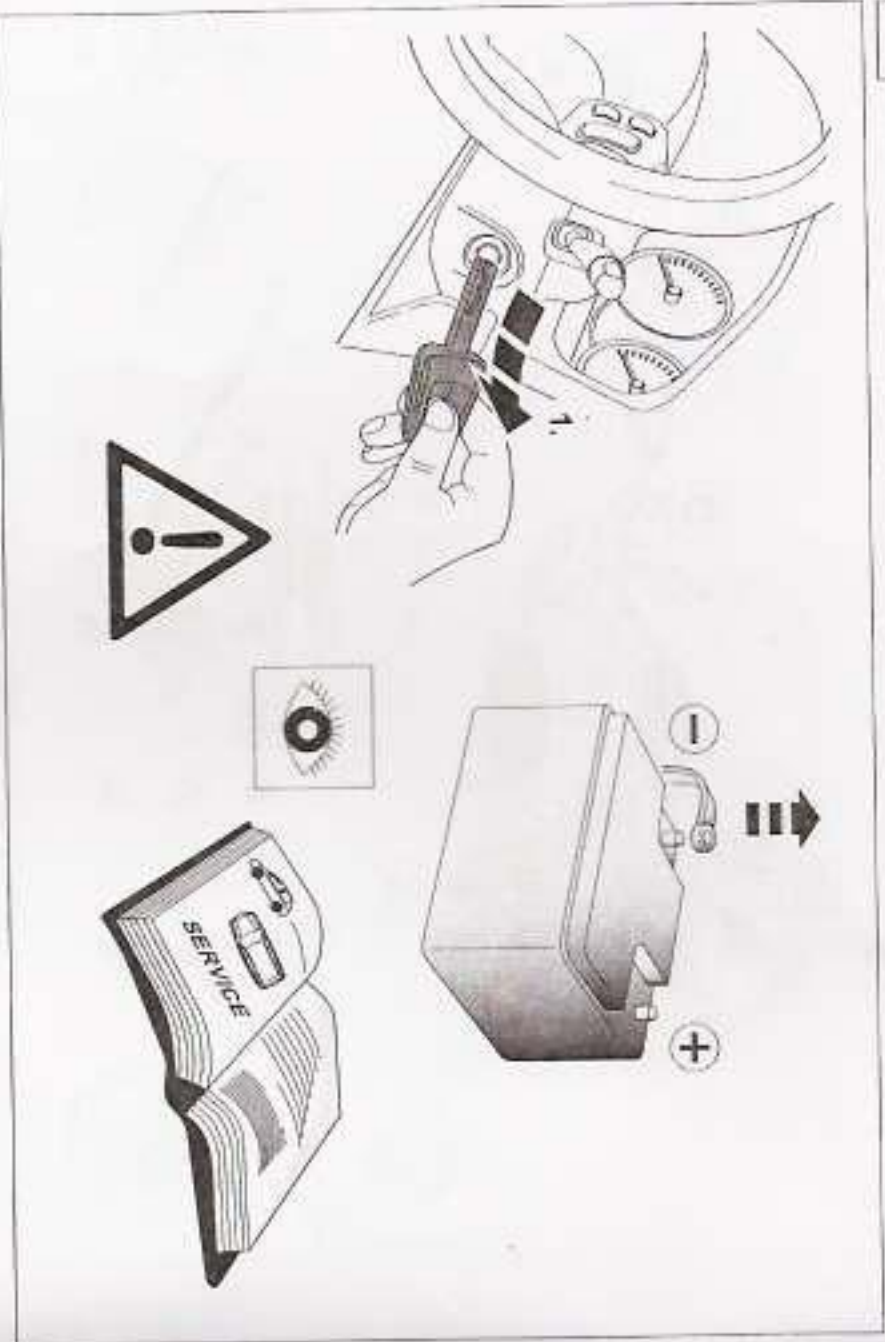

2 REMOVE

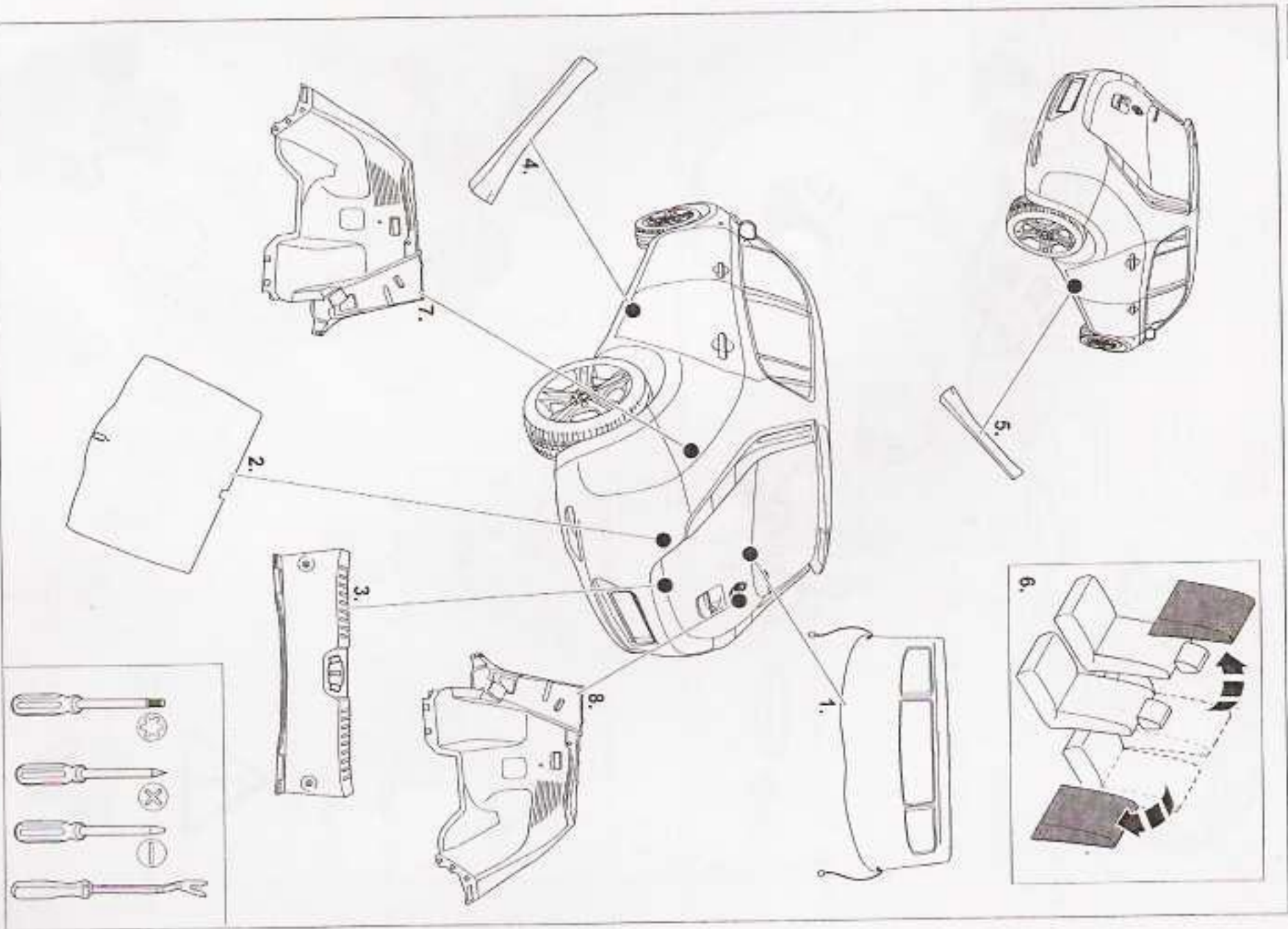

3 REMOVE

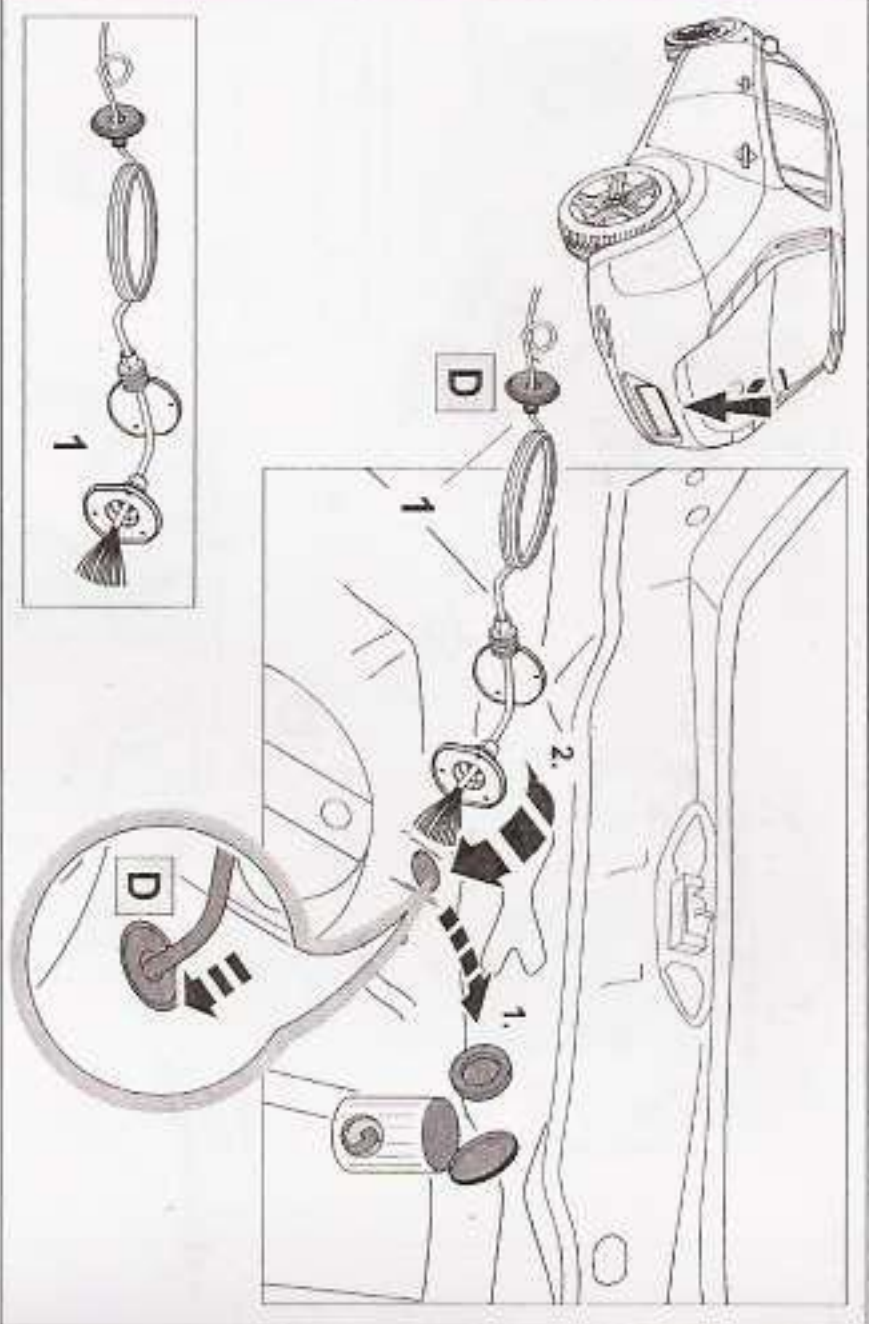

4

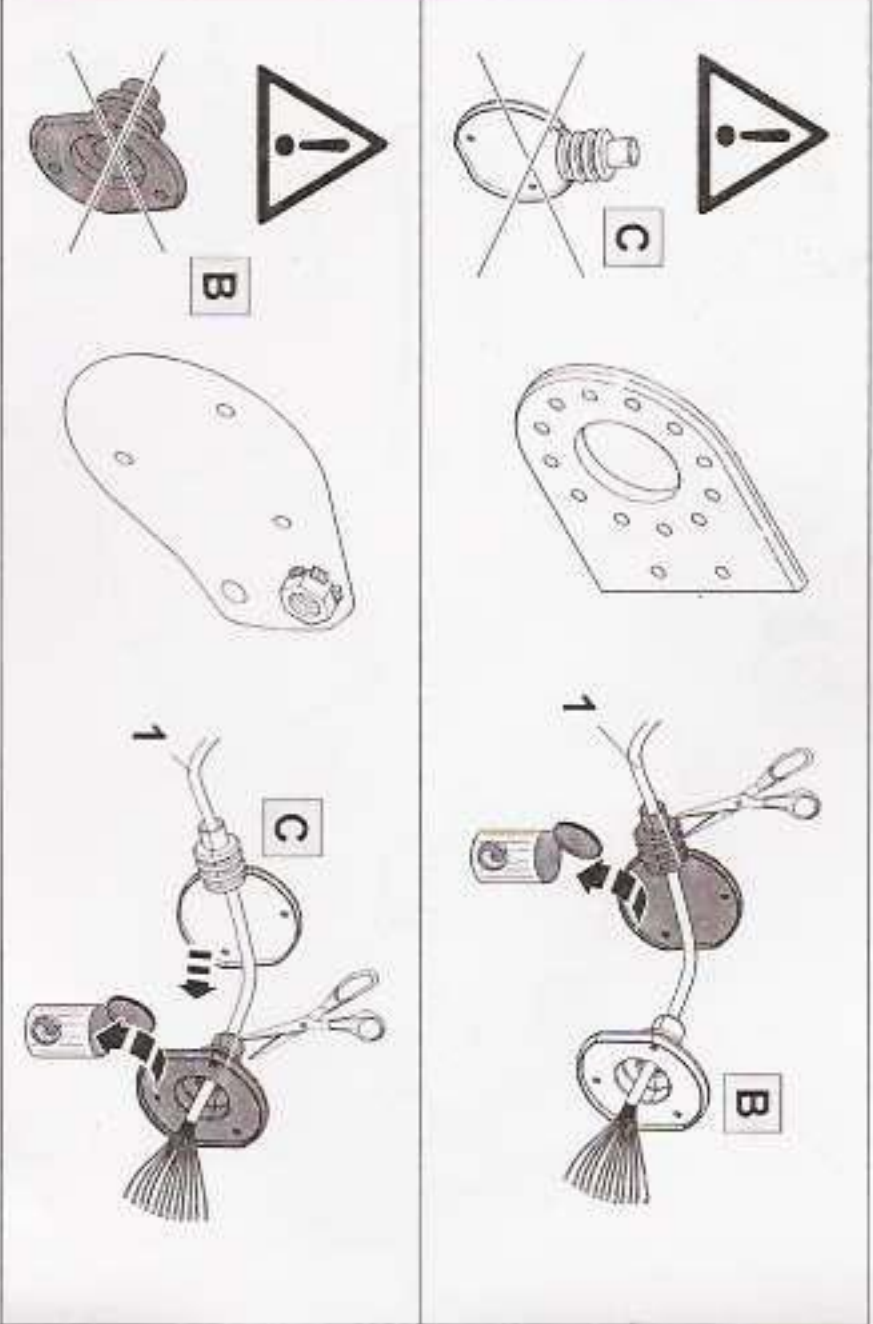

5

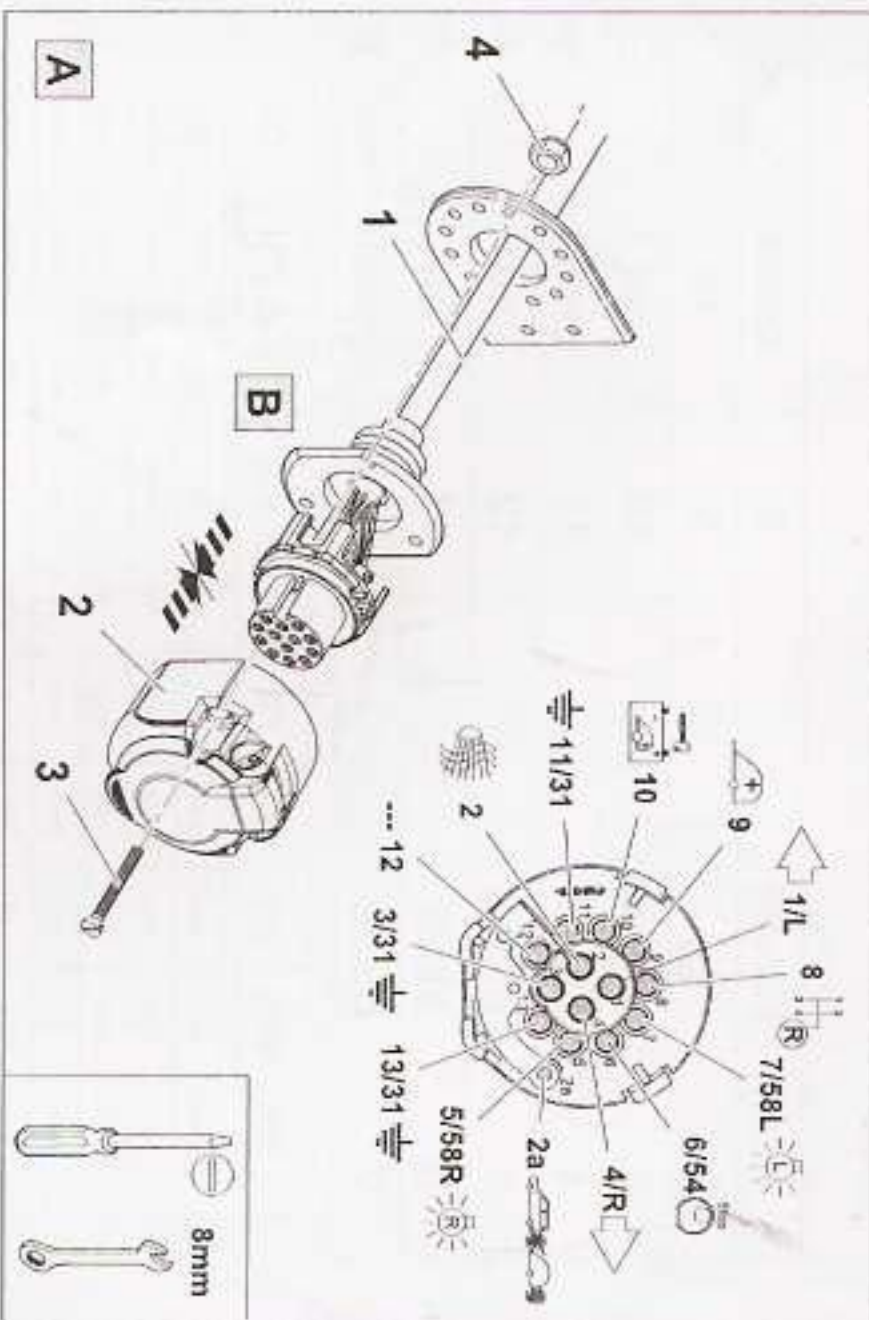
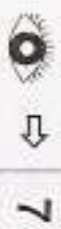

6

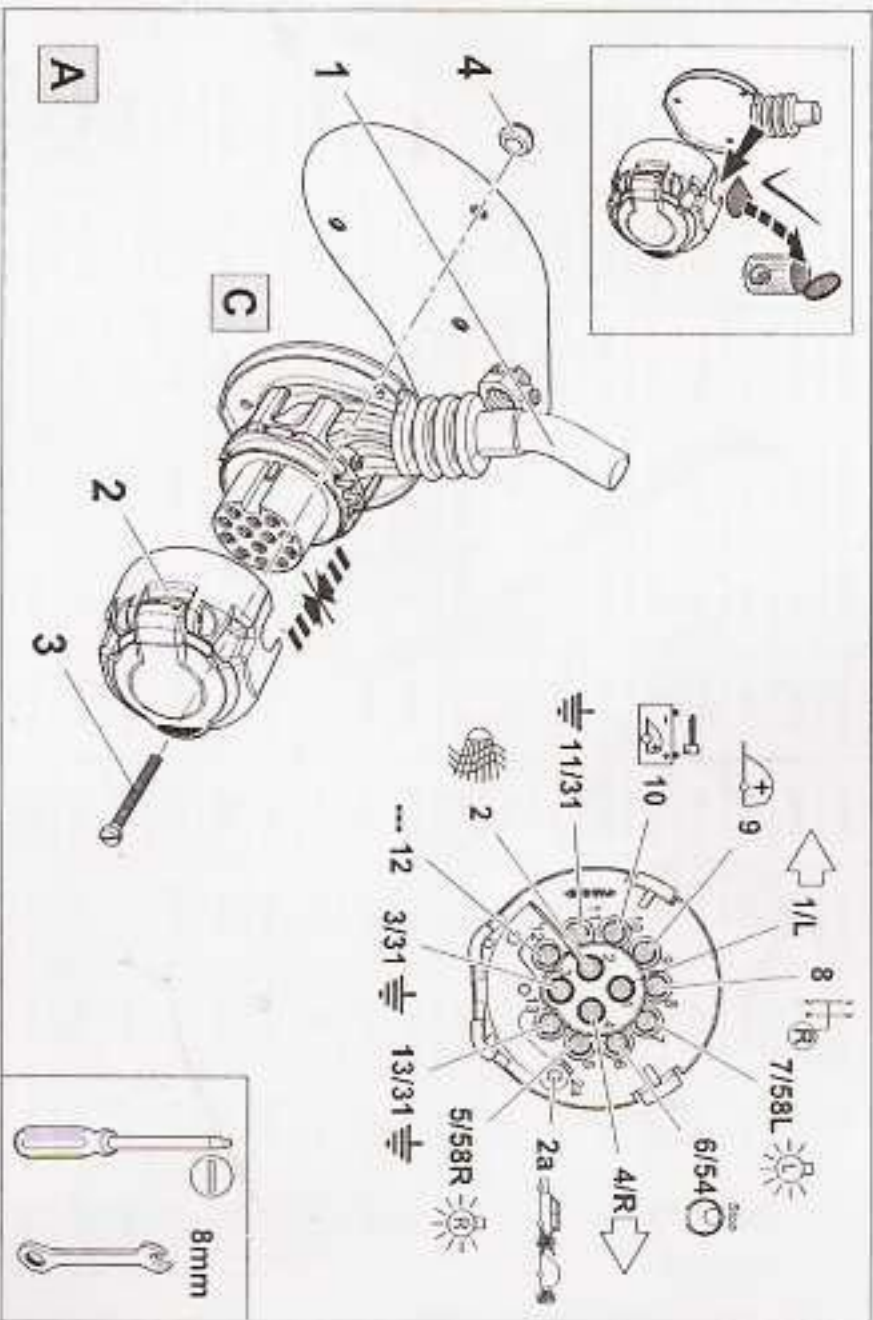

1	bk/wh					8	bu/rd		
2	gy					9	rd		
3	wh/bn					10	ye		
4	bk/gn					11	bn/gn		
5	gy/rd					12	no		
6	bk/rd					13	bn		
7	gy/bk					58b/2a	gy/wh		

8	bk	wh	gy	gn	rd	bu	ye	bn	pu	or	no
D	schwarz	weiß	grau	grün	rot	blau	gelb	braun	violett	orange	nicht belegt
GB	black	white	grey	green	red	blue	yellow	brown	purple	orange	not occupied
F	noir	blanc	gris	vert	rouge	bleu	jaune	brun	violet	orange	travaux
NL	zwart	wit	gris	groen	rood	blauw	geel	bruin	violet	orange	niet aan- gesloten
DK	sort	hvid	grå	grøn	rød	blå	gul	brun	violet	orange	ikke zwevend
N	svart	hvít	grá	græn	rauð	blá	gul	brun	fiarlit	orange	áka liðurk
S	svart	vít	grå	grön	röd	blå	gul	brun	violet	orange	använd
FIN	musta	valkoinen	harmaa	vihreä	punainen	sininen	keltainen	ruskea	violetti	oranssi	ei välttä
I	nero	bianco	grigio	verde	rosso	blu	giallo	marone	violetto	arancione	libero
E	negro	blanco	gris	verde	rojo	azul	amarillo	rojo	violeta	anaranjado	no ocupado
P	preto	branco	cinzento	verde	vermelho	azul	amarelo	castanho	violeta	laranja	ocupado
GR	μαύρο	λευκό	γκρι	πράσινο	κόκκινο	μπλε	κίτρινο	καφέ	μωβ	πορτοκάλι	Οχι είναι κούρ στη χρήση
PL	czarny	biały	szary	zielony	czerwony	niebieski	żółty	brązowy	fioletowy	pomarańczowy	wolny
CZ	černý	bílý	šedý	zelený	červený	modrý	žlutý	hnědý	fialový	oranžový	ne- obsazen
TR	siyah	beyaz	gri	yeşil	kırmızı	mavi	sarı	kahverengi	mor	portakal rengi	boş
H	leveys	rende	szürke	zöld	piros	kék	sárga	barna	bolyoskék	narancssárga	nem foglalt
HR	crno	bijelo	sivo	zeleno	crveno	plavo	zuto	smetlo	ljubičasto	narandžasto	nije zauzeto
BUL	черен	бел	сив	зелен	червен	син	жълт	кафяв	виолетов	оранжева	заетостно
RO	negru	alb	gri	verde	roșu	albastru	galben	maro	violet	portocaliu	liber
RU	чёрный	белый	серый	зелёный	красный	голубой	жёлтый	коричневый	фиолетовый	оранжевый	свободен
LT	juoda	baltas	pilkas	žalis	raudona	lydimas	geltonas	ruda	purpurinė	oranžinė	laivys
LV	melnā	baltā	pelēkā	zaļa	sarkanā	zila	dzeltenā	ruda	purpura	oranža	brīvs
IST	mafi	valda	hall	viðirna	purra	stíma	keltra	brúna	purpur- bunna	orandi	vaða
ALO	zrna	bela	siva	zelena	rdaka	modra	rumena	smred	violetast	orandžer	zasedeno ni
BK	černý	bílý	šedý	zelený	červený	modrý	žltý	hnědý	fialový	pomaran- čový	ne- obsazený

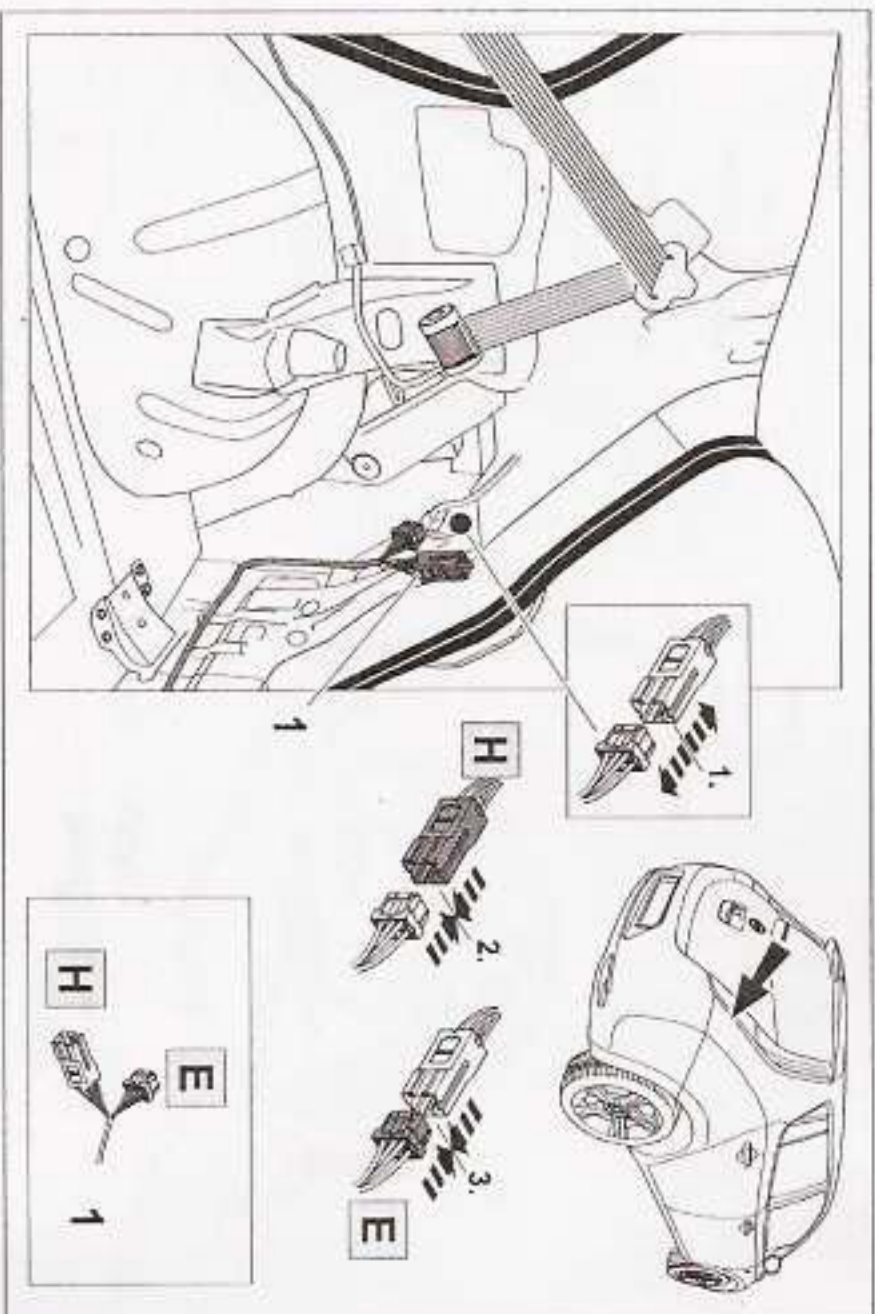
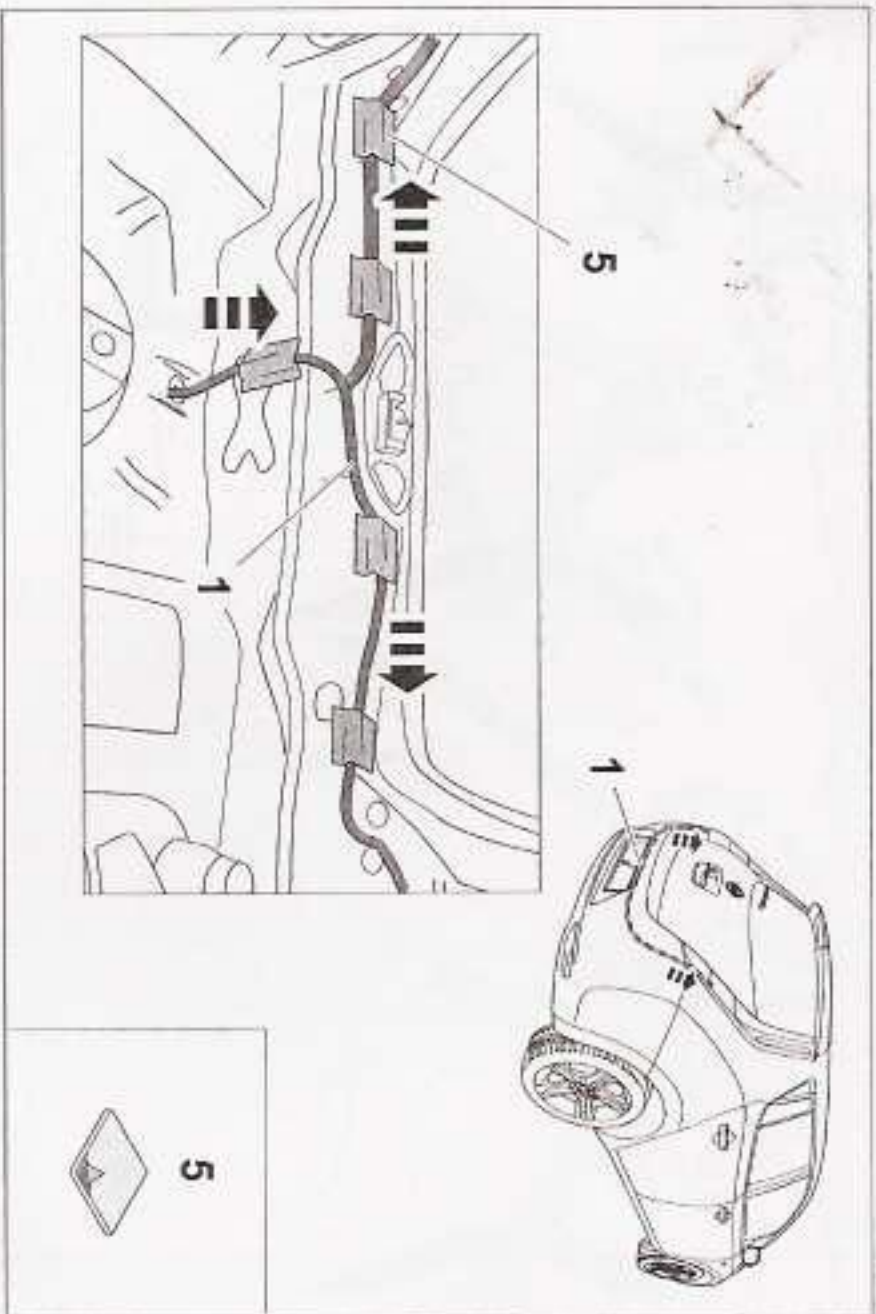

11

8

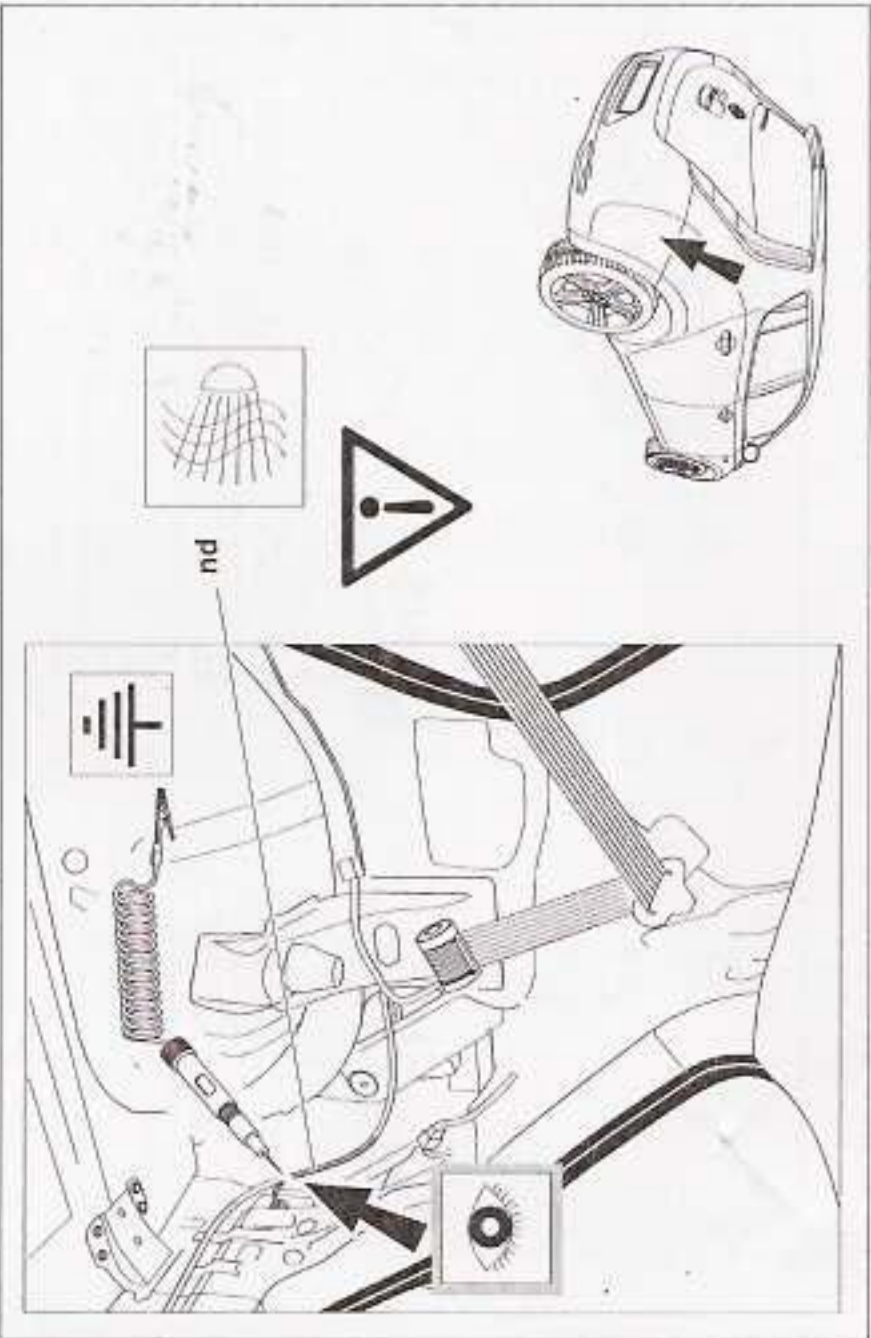

13

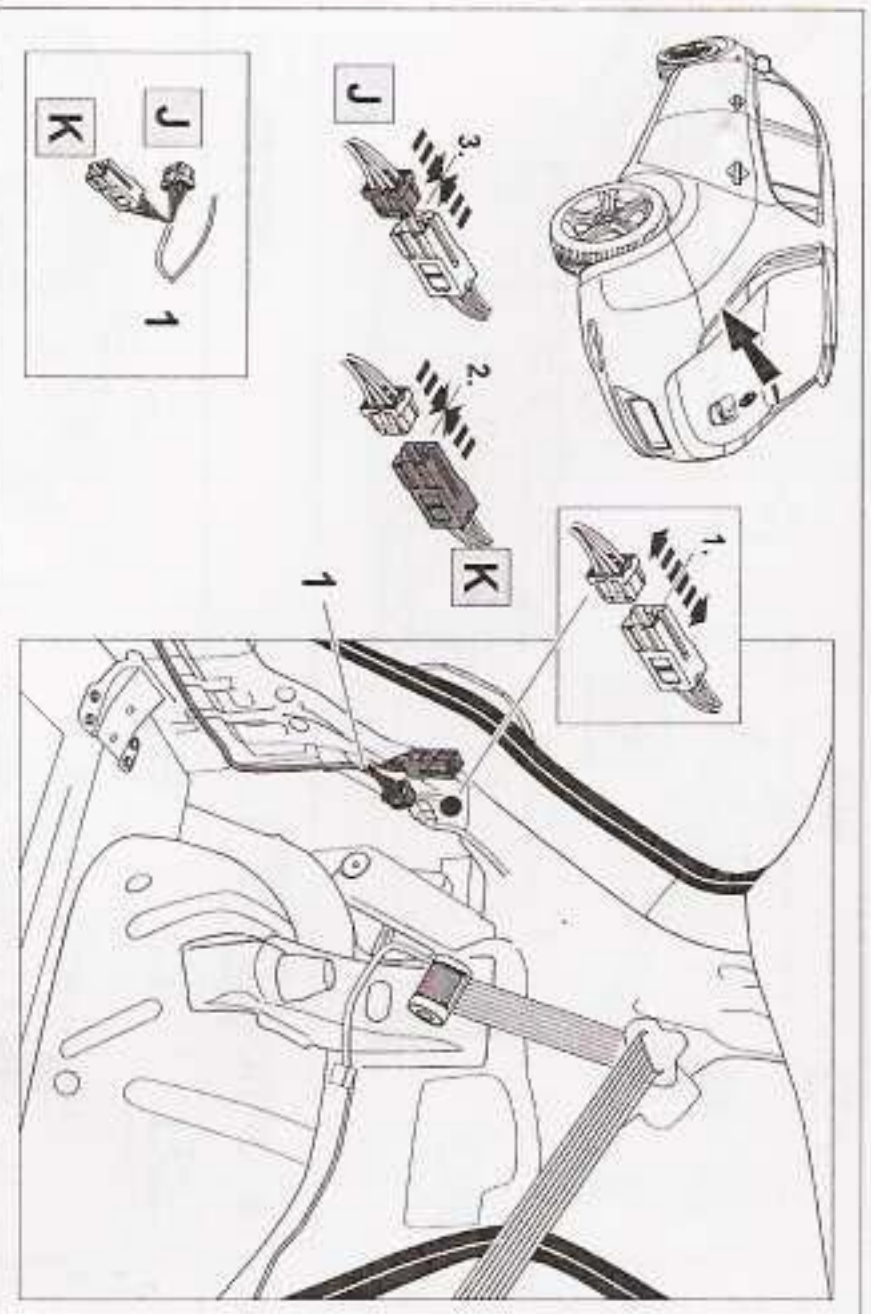

12

8

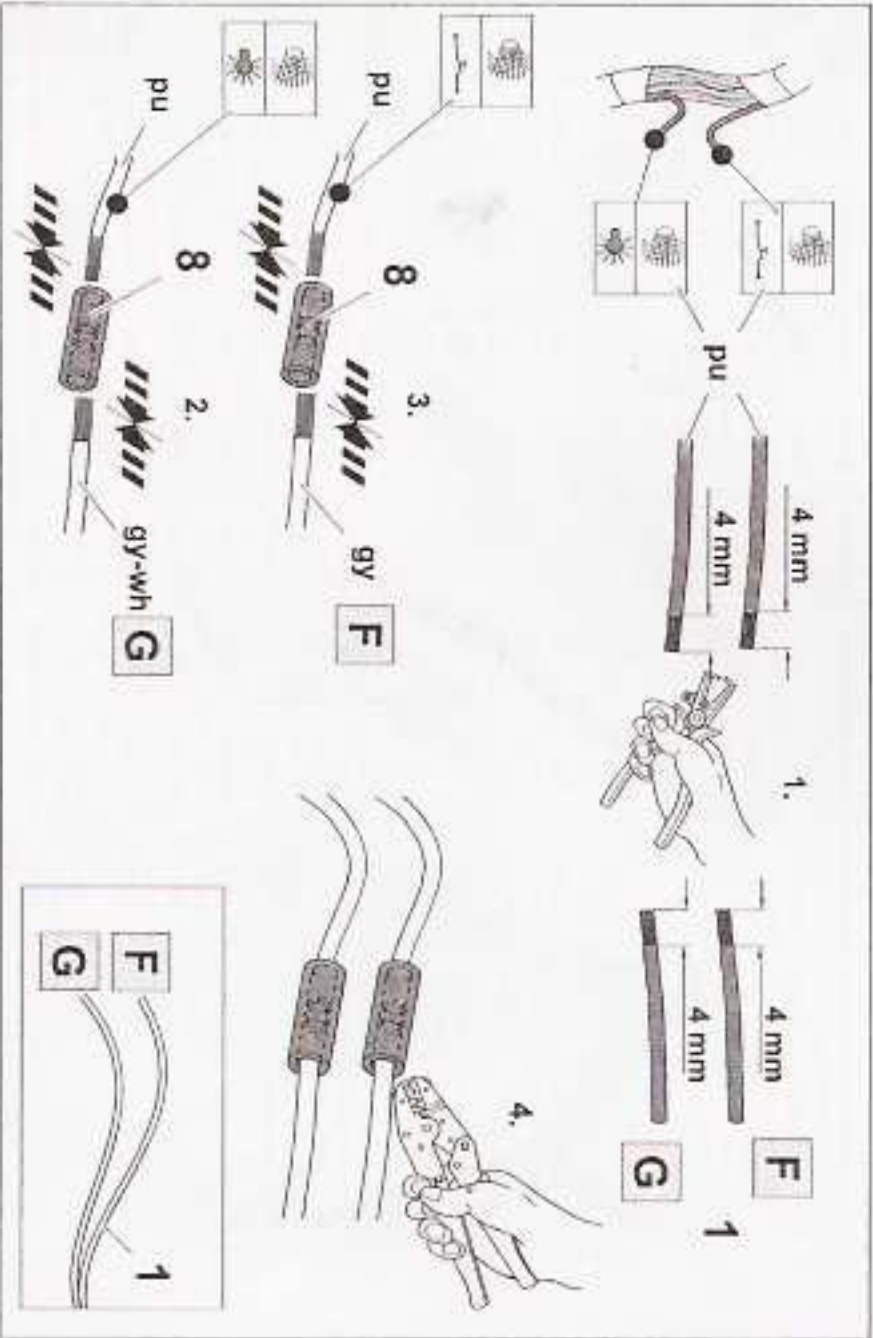

14

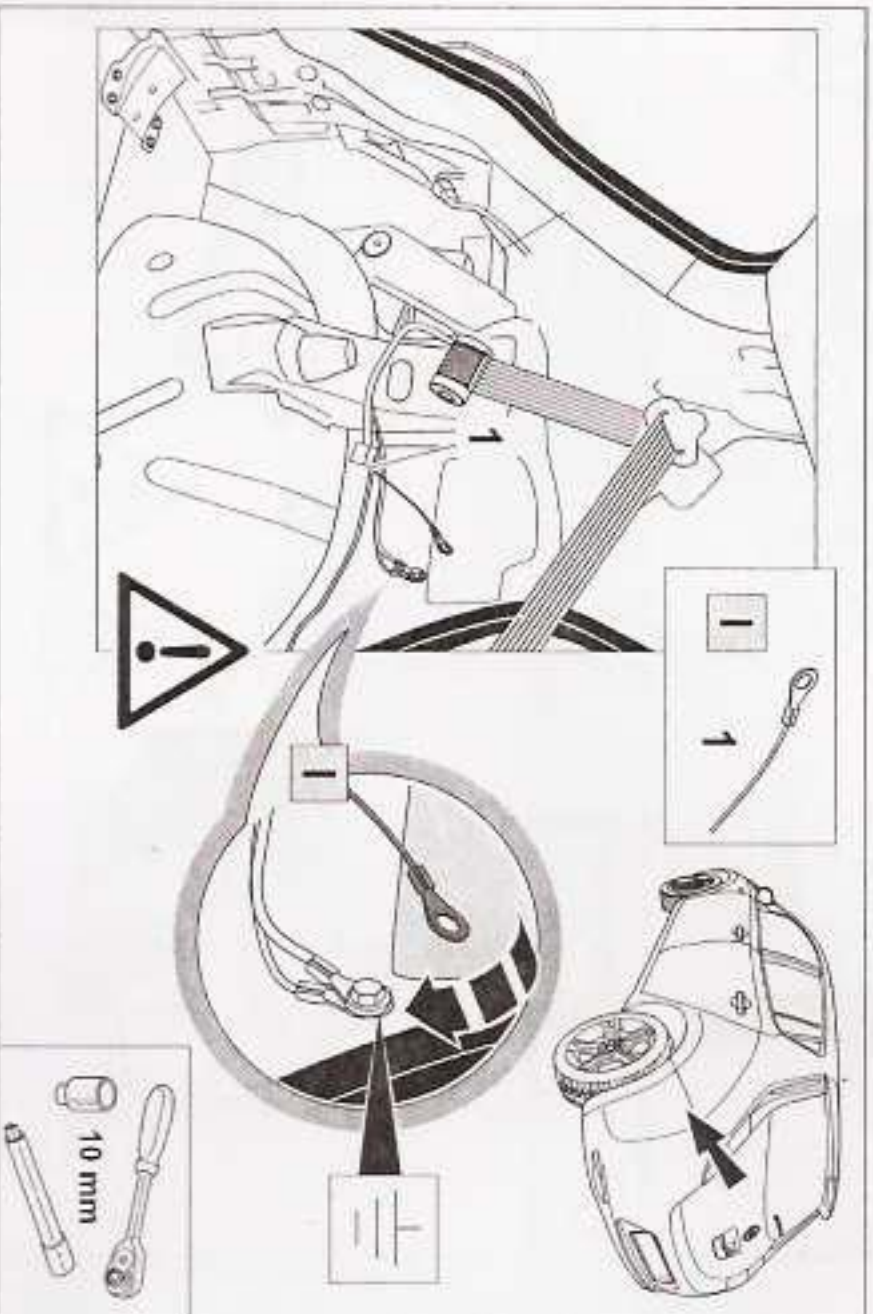

15 OPTIONAL

764129

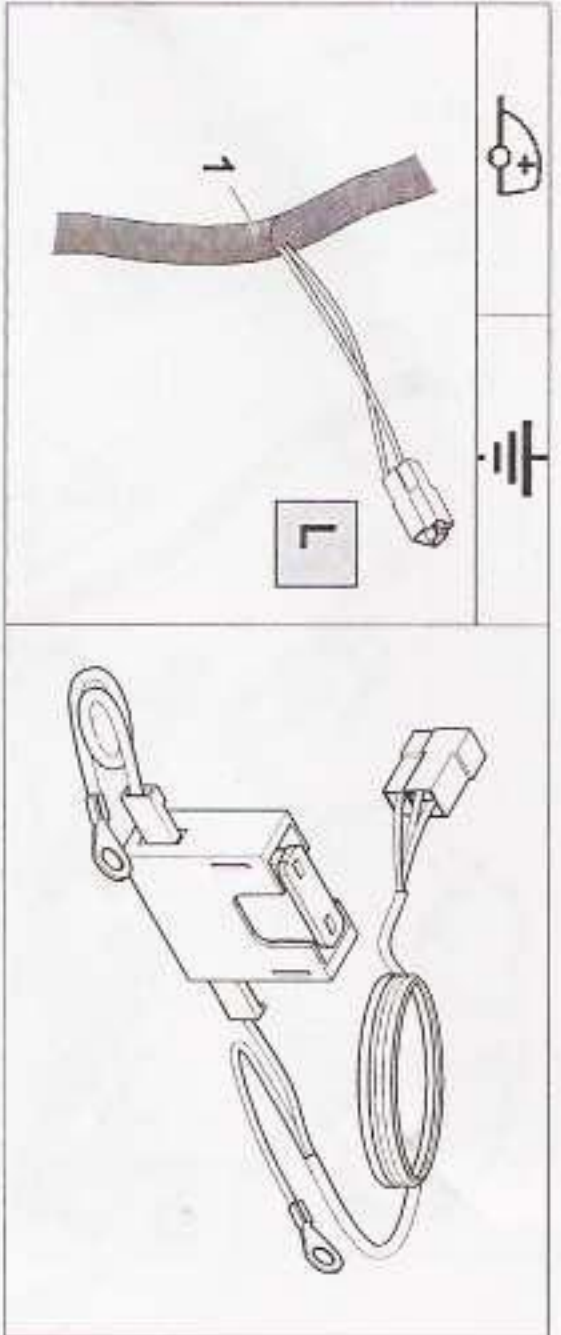

16 OPTIONAL

764139

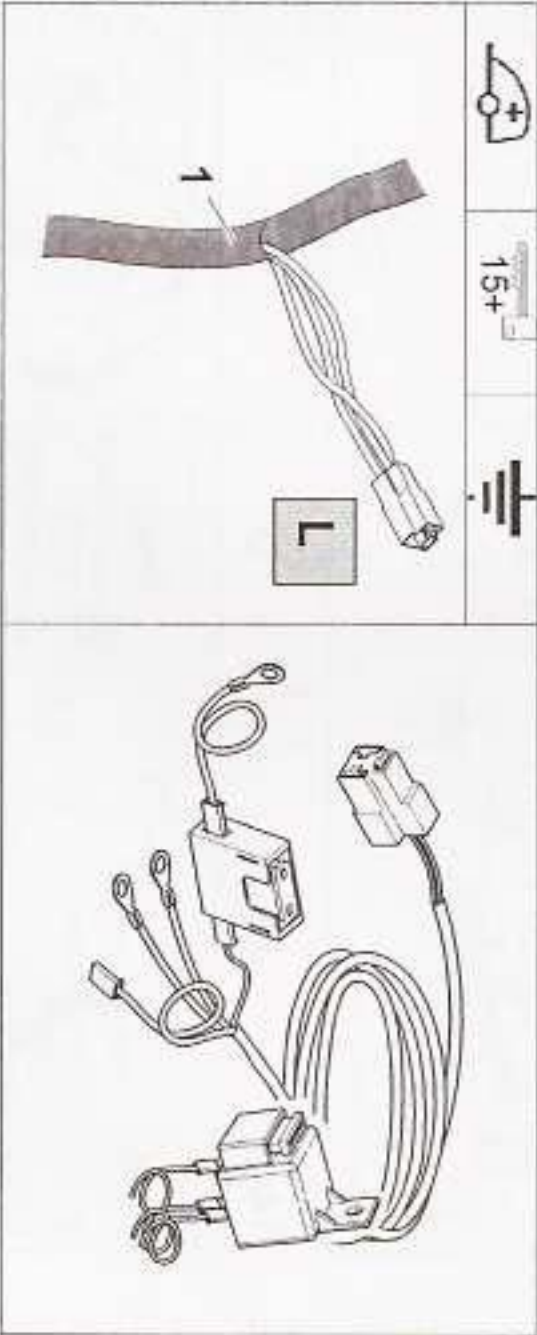

17

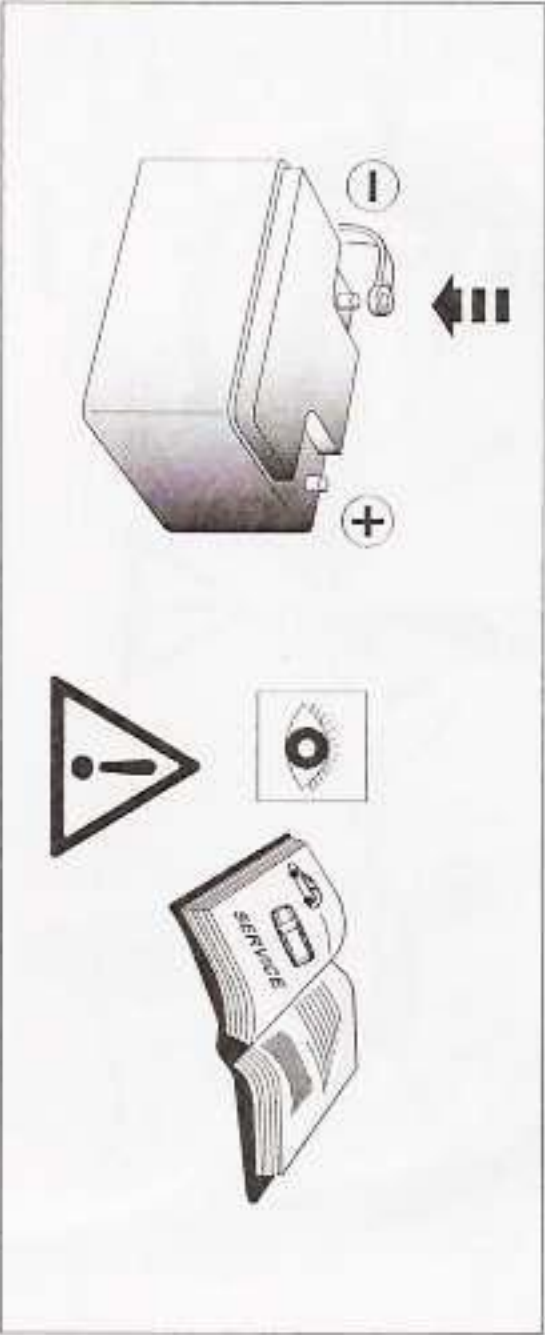

18 CHECK

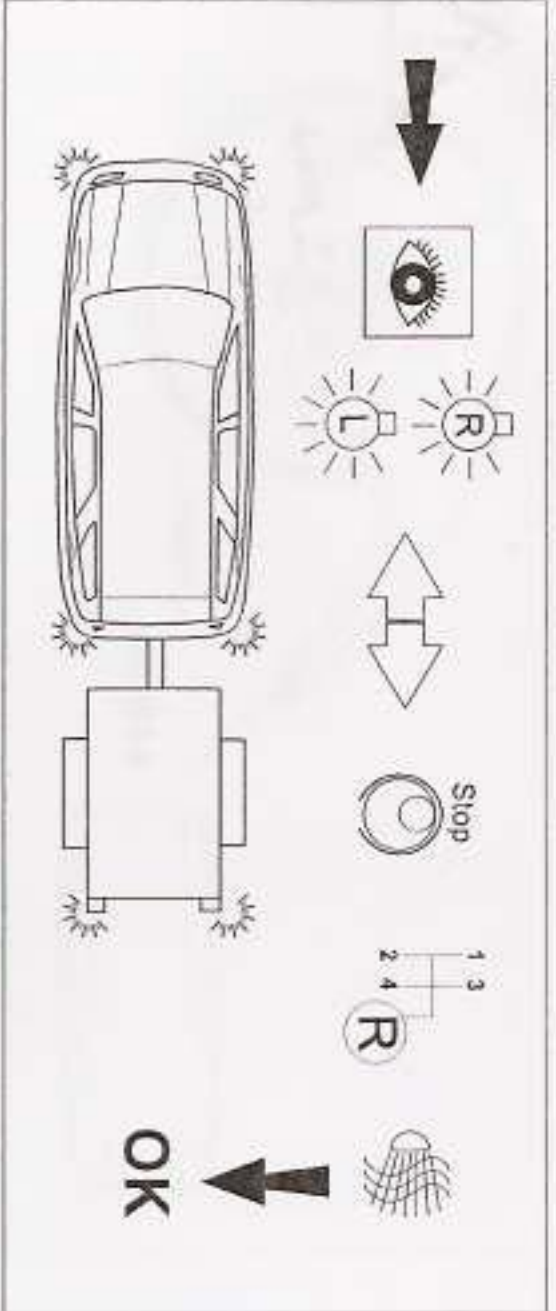

19 OPTIONAL

BRINK

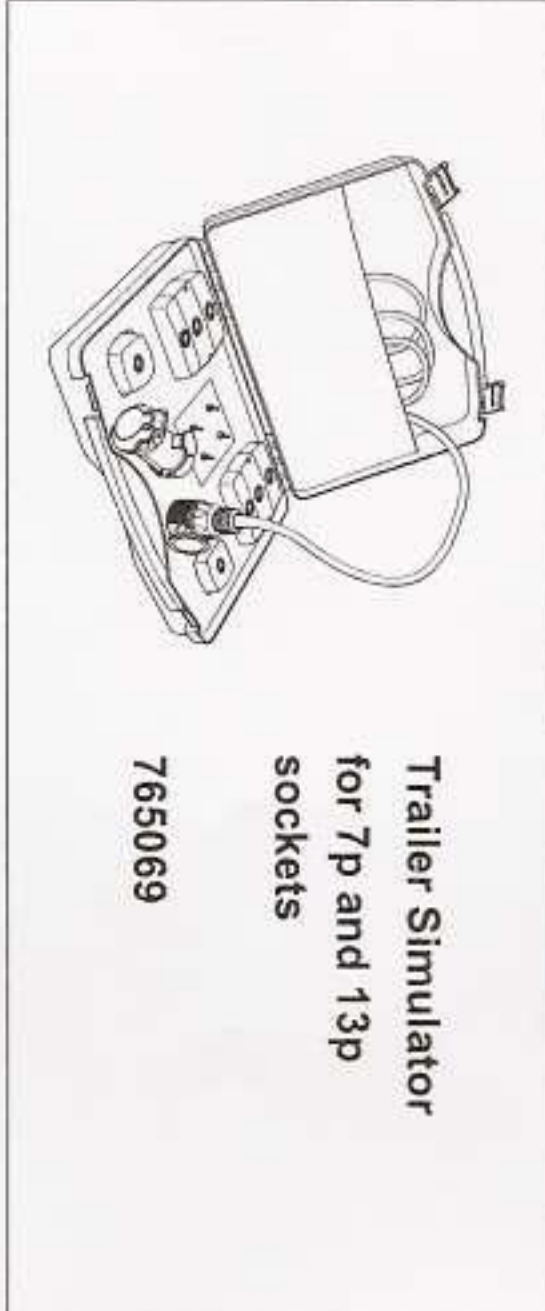

20 OPTIONAL

BRINK

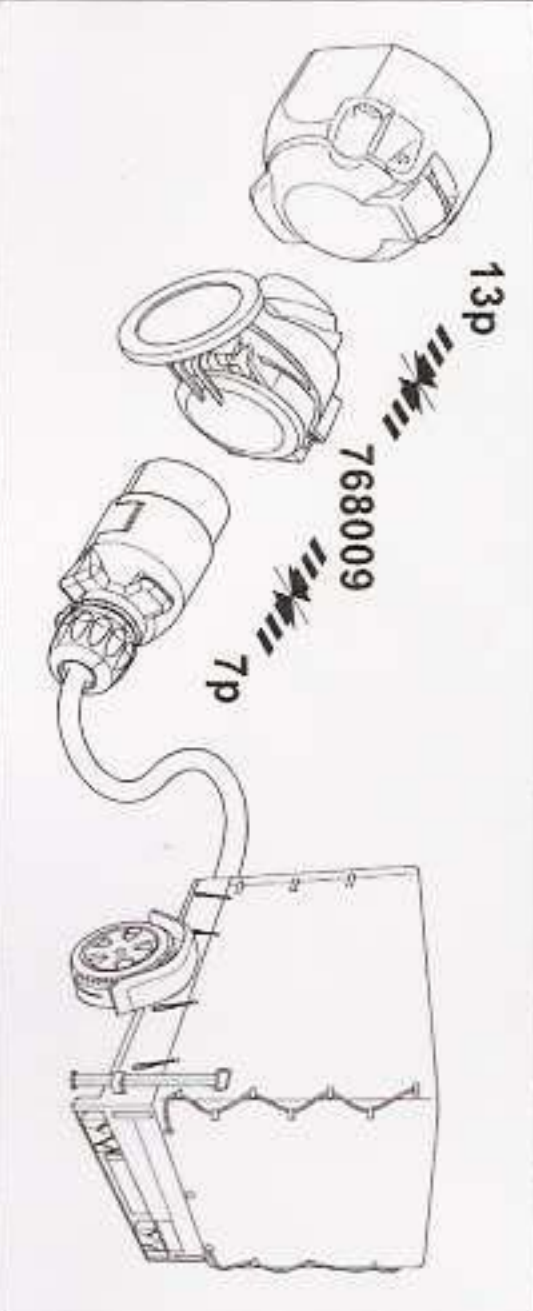

21 PLEASE NOTICE

